

# Diablo-2500 skimmer

## Introduction:

Reef Octopus Diablo-2500 skimmer is a new design with the purpose of thanks for our fans' supports. It uses the Italian pump PSK-2500 as its core and match with Reef Octopus super needle wheel to work as a skimmer pump.

Diablo-2500 skimmers use the space saving design as the Reef Octopus SSS-series skimmers. The pumps is installed in the bottom of the skimmer, not only save the space in your sump but also make water inject in skimmer chamber directly, much more efficient.

Thanks to our well-designed and manufactured, Diablo-2500 have a excellent performance, Beside that, it have good scalability, the water inlet in the skimmer chamber bottom could adapt to a variety of pumps connection, such as HY-2000S, customers could take upgrade easily.

## Installation

1. Find all the accessories; check it, make sure they are not broken.
2. Put the skimmer chamber horizontally on a flat place; insert the pumps outlet in the hole which is on the skimmer bottom.
3. Fix the silencer on its position at the chamber and install the silencer.
4. Connect the silencer and air intake device on the pump use the silicone tube.
5. Install the gate value.
6. Put the skimmer in your sump and install the collection cup.
7. Make sure the water level in your sump is at least 1.5" up to the pumps inlet.  
Plug the pump to power and adjust the bubble level in your skimmer by adjust the gate value.
8. To avoid the overflow of collection cup, please keep the skimmer working under the supervision of you for at least half an hour.

## Safety

1. Use the skimmer under marked voltage
2. The pump water inlet must be at least 1.5 inch under the water surface.
3. Keep the water clean, avoid impurities being inhaled pump.

## WARRANTY

Reef Octopus skimmers have the 1 year warranty on craftsmanship, one year on the water pump from the date of the retail purchase by the original end-user.

We are responsible for the products as long as it's been installed and used properly. Consumable spare parts are not applicable to the warranty.

Reef Octopus cannot be held liable for damages to personal property due to misuse or improper care and maintenance of the skimmer.

Reef Octopus warranty does not, under any circumstance; cover the replacement or cost of any electronic device or personal property



# Diablo-2500

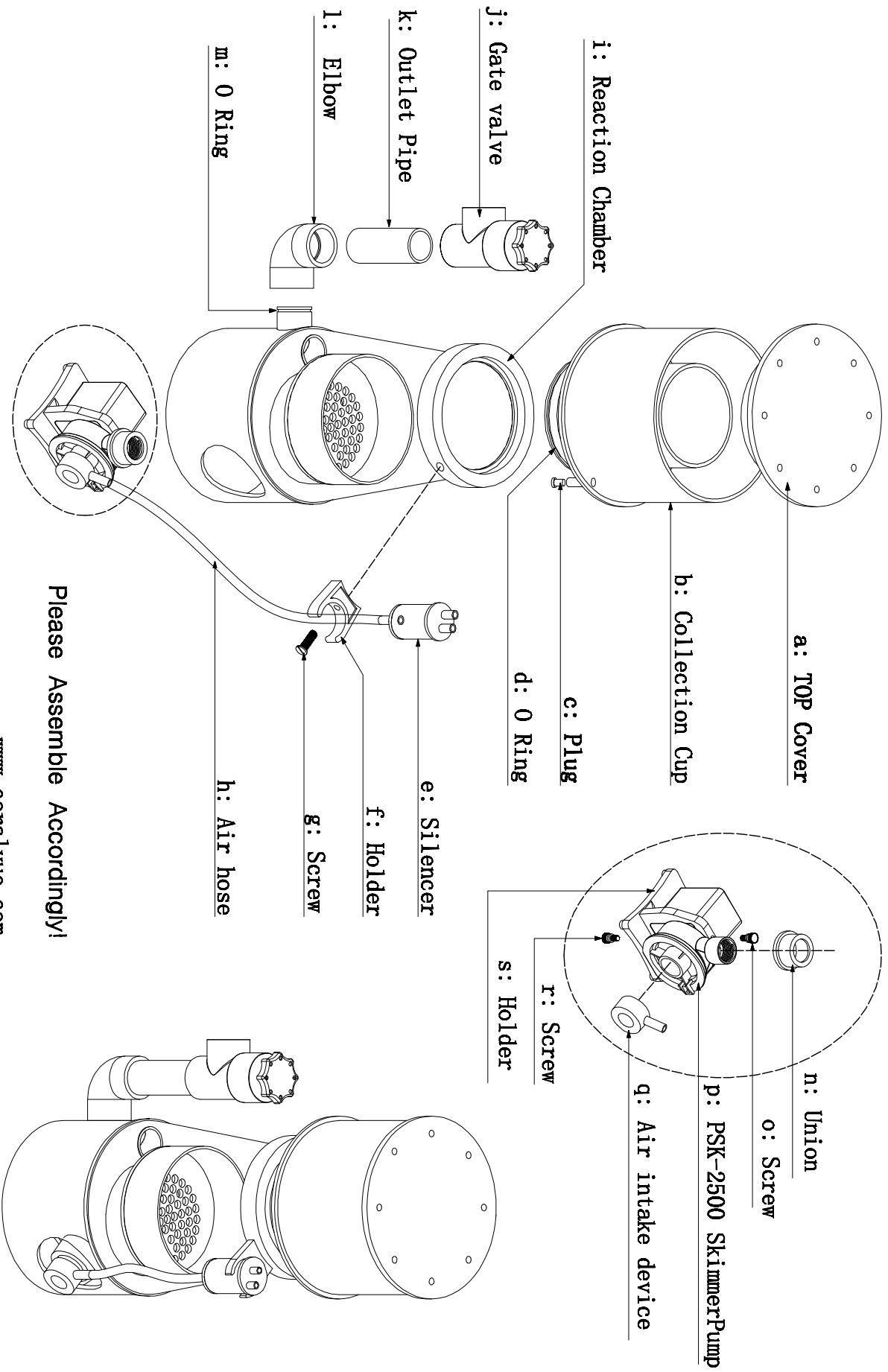

Please Assemble Accordingly!

[www.coralvue.com](http://www.coralvue.com)